



## 35 Acacia Avenue Gwynneville NSW

2 2 3

Located without doubt in one of the Illawarra's most sought after suburbs, this original brick family home offers both the space and versatility to create your dream residence. Situated on approximately 601sqm of land imagine yourself indulging in a little quiet time on the back deck embraced by private lawns and the picturesque and peaceful reserve backdrop.

Delightful characteristics include high ceilings, chandelier pendants, ornate cornice detailing and bay windows and this two bedroom, two living area home is also complimented with the modern inclusion of reverse cycle ducted air conditioning. A casual meals area adjoins the original timber kitchen and a separate, larger dining room is available for more formal experiences whilst the front

**Type** : House  
**Price** : \$ 680,000  
**Land Size** : 601 sqm  
**View** : <https://www.jacksonresidential.com.au/sale/nsw/wollongong-illawarra/gwynneville/residential/house/6046813>



**Mark Jackson**  
 02 4226 3000

[For full version visit the website](https://www.jacksonresidential.com.au)

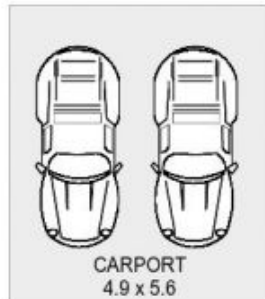

DETACHED

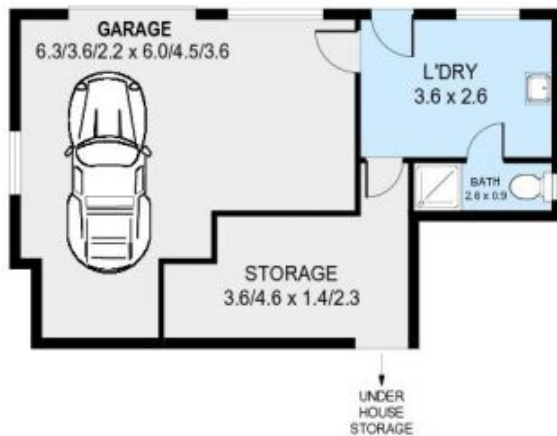

LOWER LEVEL



GROUND LEVEL

0 1 2 3 4 5

SCALE (METRES)

PLANS SHOWN ONLY INDICATIVE OF LAYOUT. DIMENSIONS ARE APPROXIMATE.  
Ref. No. 35566

INT : 130m<sup>2</sup>  
EXT : 33m<sup>2</sup>  
LOWER : 53m<sup>2</sup>  
DETACHED : 27m<sup>2</sup>

35 ACACIA AVENUE

GWYNNEVILLE